

Drehkipfenster – Kipp vor Dreh

Basisbeschlag mittig

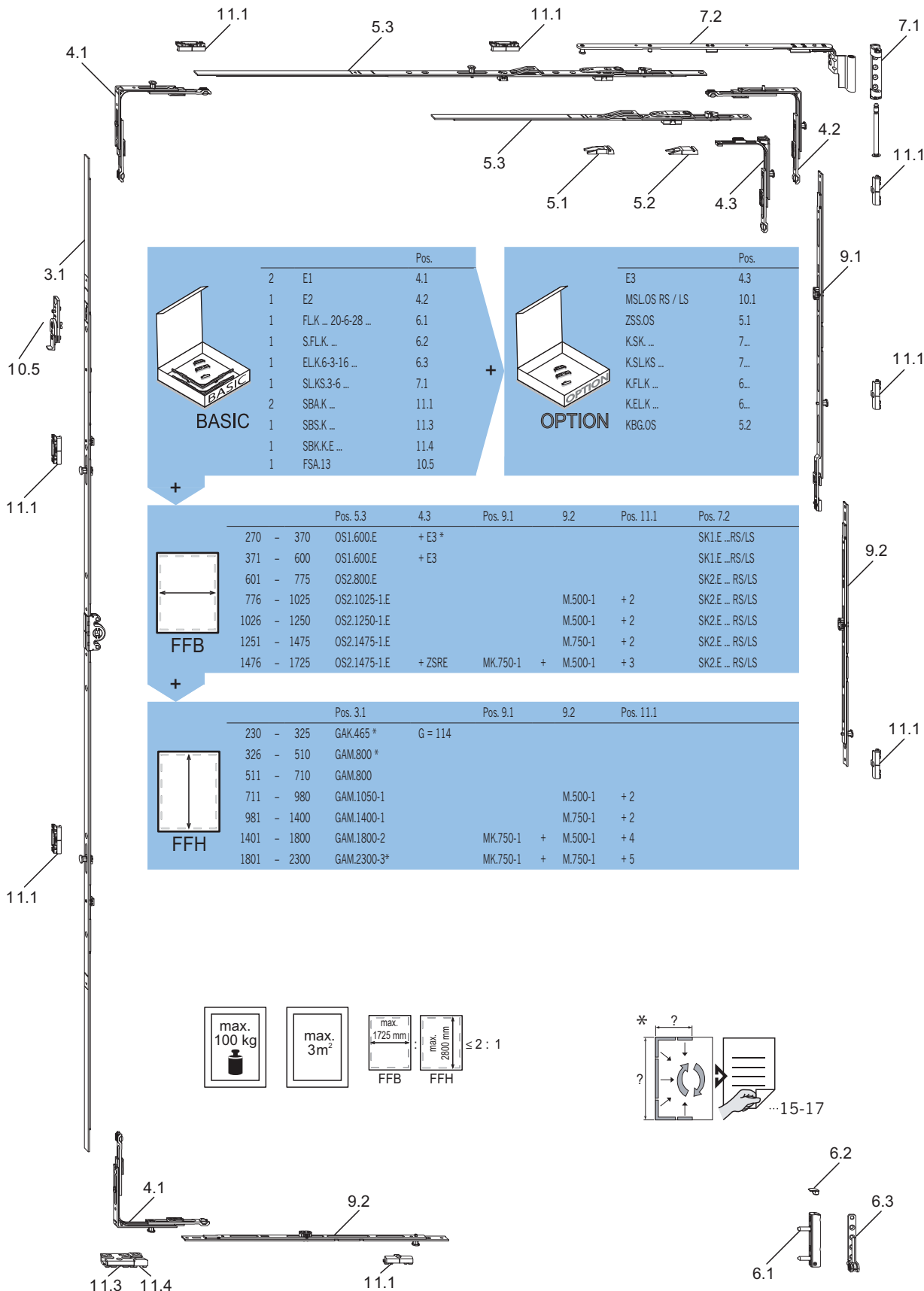
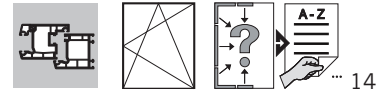

BASIC			OPTION		
		Pos.			Pos.
2	E1	4.1	E3		4.3
1	E2	4.2	M.SL.OS RS / LS		10.1
1	FL.K ... 20-6-28 ...	6.1	ZSS.OS		5.1
1	S.FLK ...	6.2	K.SK ...		7...
1	EL.K.6-3-16 ...	6.3	K.SL.KS ...		7...
1	SL.KS.3-6 ...	7.1	K.FLK ...		6...
2	SBAK ...	11.1	K.EL.K ...		6...
1	SBS.K ...	11.3	KBG.OS		5.2
1	SBK.KE ...	11.4			
1	FSA.13	10.5			

	Pos. 5.3	4.3	Pos. 9.1	9.2	Pos. 11.1	Pos. 7.2
270 - 370	OS1.600.E	+ E3 *				SK1.E ... RS/LS
371 - 600	OS1.600.E	+ E3				SK1.E ... RS/LS
601 - 775	OS2.800.E					SK2.E ... RS/LS
776 - 1025	OS2.1025-1.E		M.500-1	+ 2		SK2.E ... RS/LS
1026 - 1250	OS2.1250-1.E		M.500-1	+ 2		SK2.E ... RS/LS
1251 - 1475	OS2.1475-1.E		M.750-1	+ 2		SK2.E ... RS/LS
1476 - 1725	OS2.1475-1.E	+ ZSRE	MK.750-1	+ M.500-1	+ 3	SK2.E ... RS/LS

	Pos. 3.1	Pos. 9.1	9.2	Pos. 11.1
230 - 325	GAK.465 *	G = 114		
326 - 510	GAM.800 *			
511 - 710	GAM.800			
711 - 980	GAM.1050-1		M.500-1	+ 2
981 - 1400	GAM.1400-1		M.750-1	+ 2
1401 - 1800	GAM.1800-2	MK.750-1	+ M.500-1	+ 4
1801 - 2300	GAM.2300-3*	MK.750-1	+ M.750-1	+ 5

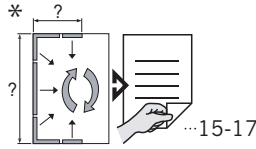
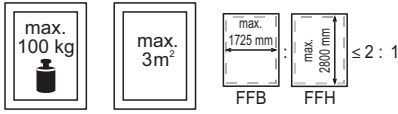
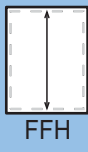

- 1 Allgemeine Produktinformationen
- 2 **Beschlagübersichten**
- 3 Getriebschienen
- 4 Eckumlenkungen
- 5 Oberschienen
- 6 Flügellager/ Ecklager
- 7 Scheren/ Scherenlager
- 8 Drehlager/ Kippbänder
- 9 Zusatzverriegelungen
- 10 Zubehör
- 11 Rahmenteile
- 12 Anschlaghilfen
- 13 Montageanleitung
- 14 Justierung/ Wartung
- 15 Einbauzeichnungen